

FEMALE X FEMALE CONNECTION  
SMV2-WFX

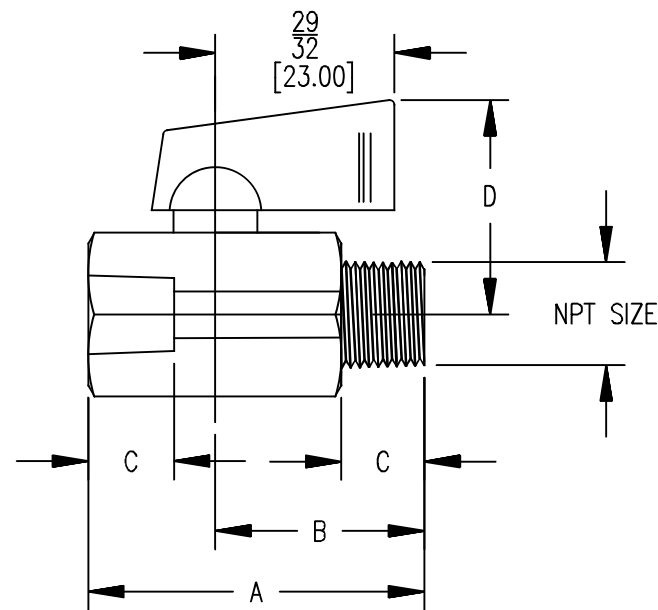

MALE X FEMALE CONNECTION  
SMV2-WMX

MODEL #	A IN [mm]	B IN [mm]	C IN [mm]	D IN [mm]	NPT
SMV2-WF1	1-9/16	13/16	25/64 [10.00]	1-3/64 [26.30]	1/8"
SMV2-WF2	[39.50]	[20.50]			1/4"
SMV2-WF3	1-1/2 [38.00]	3/4 [19.00]	19/32 [15.30]	1-3/32 [28.00]	3/8"
SMV2-WF4	2-7/64 [53.50]	1-3/32 [28.00]			1/2"
SMV2-WM1	1-47/64 [44.00]	63/64 [25.00]	25/64 [10.00]	1-3/64 [26.30]	1/8"
SMV2-WM2					1/4"
SMV2-WM3					3/8"
SMV2-WM4	2-13/64 [56.00]	1-13/64 [30.50]	19/32 [15.00]	1-3/32 [28.00]	1/2"

Ⓢ = CRITICAL DIMENSION  
STANDARD TOLERANCES UNLESS NOTED:  
ALL DECIMAL DIMENSIONS ± .005  
ALL ANGLES ± 1°

			DATE 7-10-14	NAME  ARTWORK SERIES SMV2 MINI STAINLESS STEEL BALL VALVE  (FOR REFERENCE ONLY)  ACAD2002	MATERIAL
			DWN BY CM		FINISH
			CHKD HMA		<b>DWYER INSTRUMENTS, INC.</b> MICHIGAN CITY, INDIANA 46360 U.S.A.
NO.	CHANGES	BY/DATE	APPD DKG		

NOTICE: This drawing and the principles and elements of design embodied therein are the exclusive property of DWYER INSTRUMENTS, INC. and are not to be communicated, disclosed, reproduced or used except as previously authorized in writing by such corporation and must not be submitted to outside parties for examination without the written consent of said corporation.